

MOISTURE HOLDERS DIN 42562 / EN 50216-5

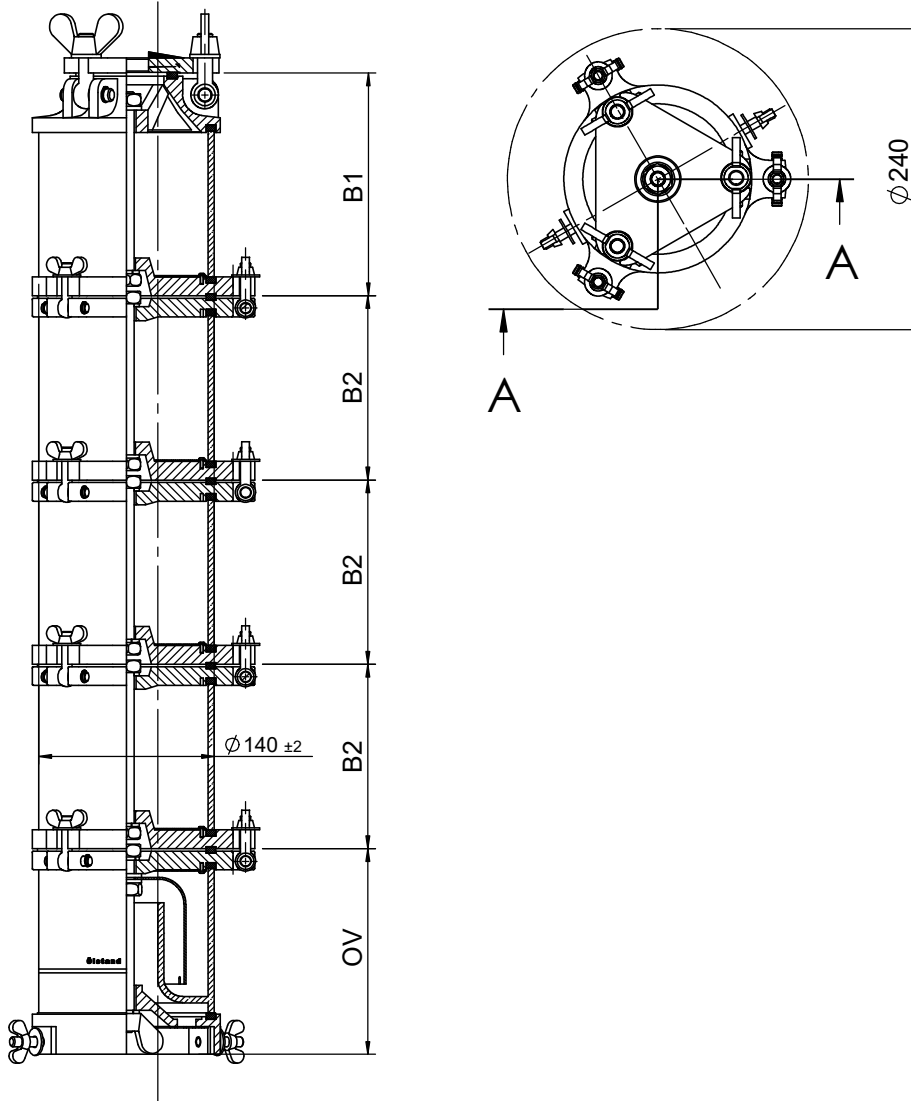

DIN 42562		
Type	Code No	Silicagel Capacity
DIN 42562 -L1	641	1.2
DIN 42562 -L2	651	2.4
DIN 42562 -L3	661	3.6
DIN 42562 -L4	671	4.8

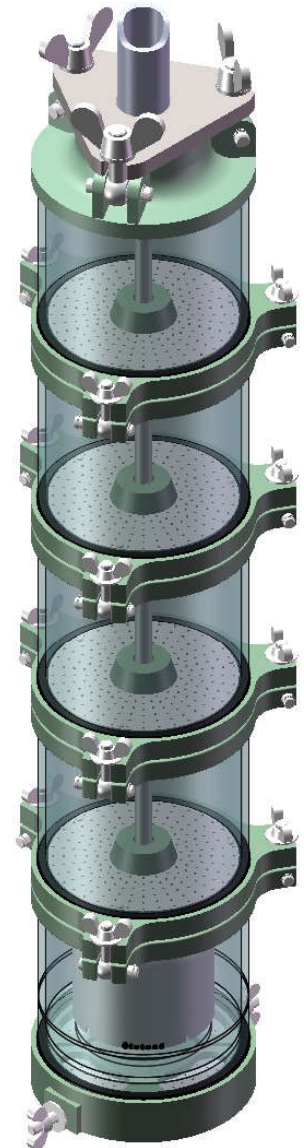

Types of moisture holders		L1	L2	L3	L4
Silicagel amount	Kg	1.2	2.4	3.6	4.8
Height (h)	± 0,3 mm	342	489	636	783
Weight of moisture holders without silicagel (no filling)	Kg	9.2	12.6	16.3	20
Assembly groups	B1	1	1	1	1
	B2	-	1	2	3
	OV	1	1	1	1

MOISTURE HOLDERS DIN 42562 / EN 50216-5

COMPONENT LIST					
Number	Grouping			Description	Explanation
	B1	B2	OV		
1	1	1	-	Partition plate	AL - RAL 7033
2	-	1	1	Partition plate	AL - RAL 7033
3	1	-	-	Top section	AL - RAL 7033
4	-	-	1	Bottom section	AL - RAL 7033
5	-	-	-	Flange	S235JR
6	1	1	1	Glass cylinder	Cam / Glass
7	-	-	1	Oil container	Cam / Glass
8	-	-	1	Dome	inox
11	1	1	-	Perforated plate	Al
12	-	-	1	Perforated plate	Al
13	-	-	1	Perforated plate	Al
14	1	-	-	Gasket	NBR 70
15	2	3	3	Gasket	NBR 70
16	-	-	2	Gasket	PA6
18	-	-	1	Bolt	M12x150 - inox
19	-	1	-	Bolt	M12x130 - inox
20	1	-	-	Bolt	M12x140 - inox
22	-	-	2	Stud bolt	M8x30 - inox
23	3	-	-	Eyebolt	M12x55 - inox
24	-	3	3	Eyebolt	M8x40 - inox
25	1	1	2	Hexagon nut	M12 - inox
26	3	-	1	Wing nut	M12-C - inox
27	-	3	5	Wing nut	M8-C - inox
28	1	1	2	Spring washer	inox
29	3	3	7	Pin	AL
30	-	6	6	Circlips	inox
31	6	-	-	Circlips	inox
32	*	*	-	Silicagel	*=1,200gr
33	3	-	-	Washer	inox
34	-	3	5	Washer	inox
35	3	-	-	Stud	inox
36	-	3	3	Stud	inox

